

**FordKA**

# Your Technical Supplement 22

**FordParts**

Feel the difference



- The required amount for one component repair is as follows: 16 ml WB EP primer 2 ml Activator

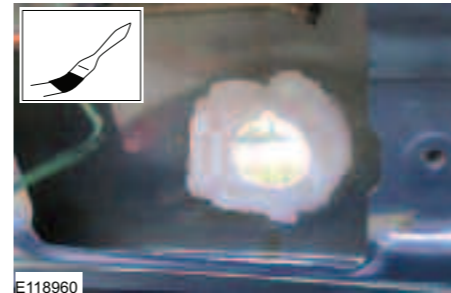

14. Apply WB EP primer on the inside of tailgate sheet metal and/or spare part including the cut edge of the opening

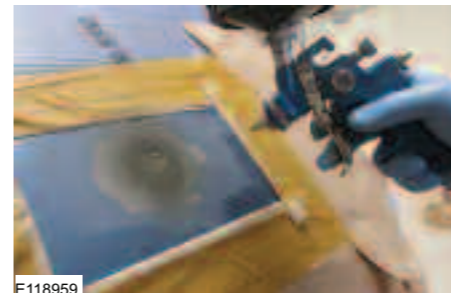

15. Apply 2K-Acrylic-Filler as specified by the manufacturer and prepare the tailgate for paint



16. Paint the affected area with base coat and top coat as specified by the manufacturer
17. Apply corrosion wax to the repair area of the inner side panel

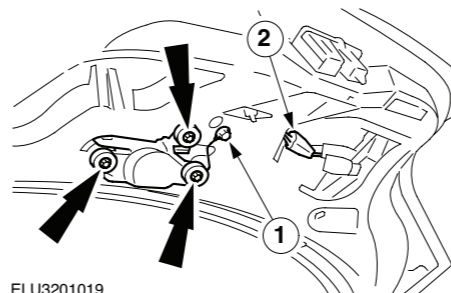

18. Install the wiper motor
  - Connect the earth lead
  - Connect the connector



19. To install, reverse the removal procedure

20. Finally corrosion wax should be applied to the rubber grommet gaps to make sure the connection to the sheet metal is watertight

## Front suspension noise

**Model:** Ka

**Summary:** Should a customer express concern about a creaking noise from the front suspension during slow speed acceleration or braking, the bolts securing the front suspension arm bracket to the vehicle may require renewal using revised bolts

### Parts Required

Description	Finis
Bolt (four off)	1 054 474

### Service Instruction

1. Raise the vehicle
2. Remove and discard the two rear suspension arm bracket bolts from both sides of the vehicle

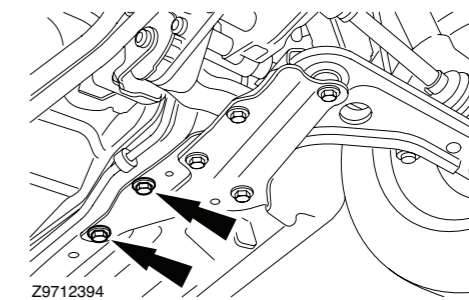

3. Install new revised bolts

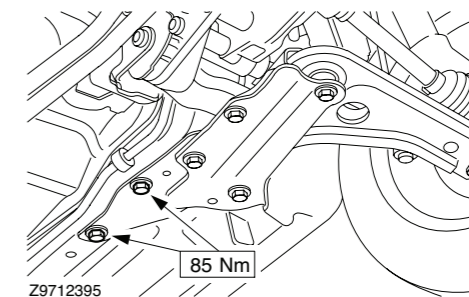

4. Lower the vehicle

# Corrosion spots on the tailgate around the opening for the rear window wiper motor

**Model:** Ka 1997 (09/1996-07/2008)

**Summary:** Should a customer express concern about corrosion spots on the tailgate around the opening for the rear window wiper motor, this may be caused by moisture and dirt entering behind the grommet and movement of the grommet in the tailgate.

**NOTE:** It is not required to install a complete new tailgate.

To rectify this concern, a new sheet metal repair spare part for the tailgate has been developed.

## Parts Required

Description	Finis
WB EP Primer (500 ml) (16 ml are essential for one component repair)	1 594 594
Aktivator for WB EP primer (125 ml) (2 ml are essential for one component repair)	1 594 600
Corrosion protection wax (10 ml are essential for one component repair)	1 219 834
Sheet metal repair spare part for the tailgate (if required)	1 673 492
2K-Adhesive (If required)	1 203 241
Emblem (If required)	Contact your Ford dealer

## Service Instruction

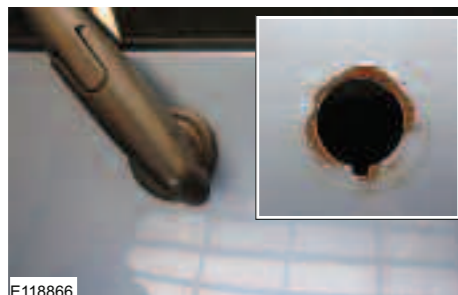

Example of corrosion spots on the tailgate around the opening for the rear window wiper motor

## Service Instruction

**Remove corrosion spots on the tailgate around the opening for the rear window wiper motor**

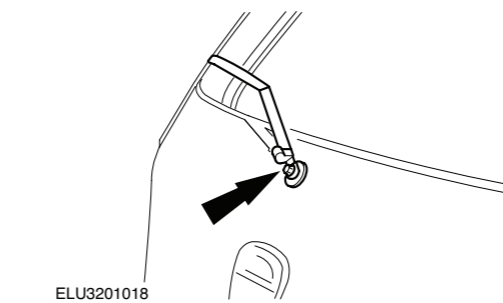

1. Disconnect the battery negative lead

2. **NOTE:** The wiper motor must be in the parked position  
Detach the wiper arm

- Open the plastic cap and undo the nut two turns
- Fold back the wiper arm and release it from the taper by moving it sideways
- Unscrew the nut and remove the wiper arm

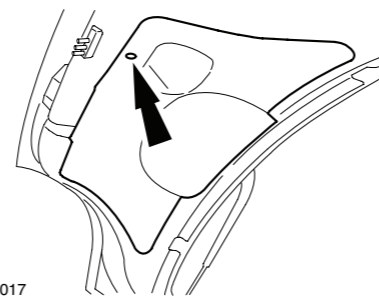

3. Remove the tailgate trim panel (one screw, eight clips)

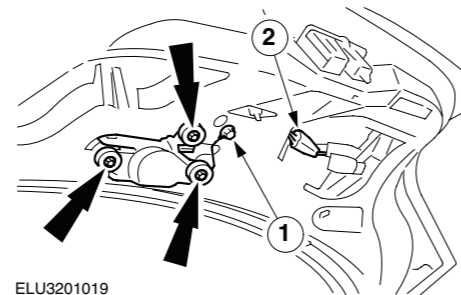

4. Remove the wiper motor

- Disconnect the earth lead
- Separate and unclip the connector

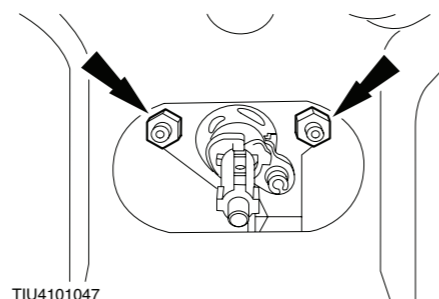

5. Remove the barrel to handle retaining nuts

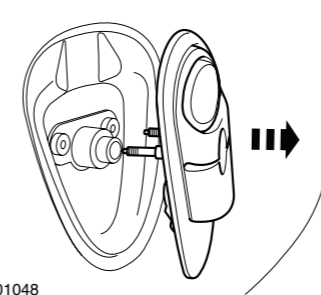

6. Remove the exterior handle

7. Remove the emblem from the tailgate

## Remove corrosion spots on the tailgate

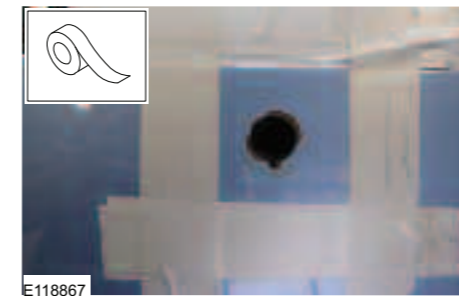

8. Mask off not affected parts to avoid damage to the paint work

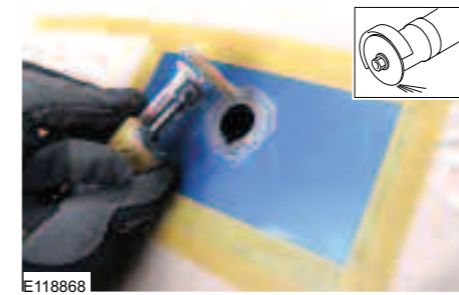

9. Remove any corrosion on the outside of tailgate sheet metal using a narrow, coarse rotating wire brush or suitable tools



10. Remove any corrosion on the inside of tailgate sheet metal using a narrow, coarse rotating wire brush or suitable tools

- Clean the repair area with compressed air

## Prepare and install sheet metal repair spare part and prepare for painting (if required)

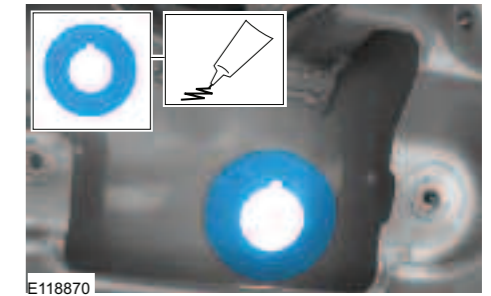

11. **NOTE:** All instructions provided by the manufacturer of the adhesive must be followed

- If the diameter of opening is found out of round for more than 1 mm the sheet metal spare part should be used. The sheet metal repair spare part for the tailgate should be bonded to the inner side of the tailgate using 2K-adhesive

- Prepare the sheet metal repair spare part for the tailgate in reference to the corroded level

- Fix the sheet metal repair spare part until the 2K-adhesive has dried completely

12. **NOTE:** All instructions provided by the manufacturer must be followed

- After necessary surface preparation apply polyester stopper as specified by the manufacturer to the repair area as required

- Grind the polyester stopper as required

## Paint Preparation

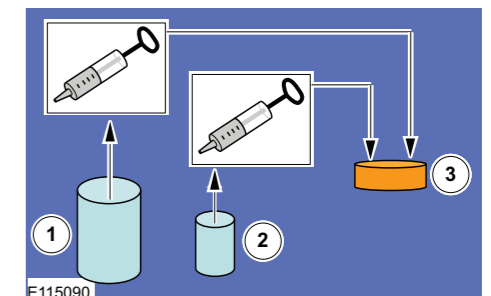

13. **WARNING:** Avoid skin contact! Protective clothes, chemical resistant gloves and goggles according to the Safety Data Sheet of the manufacturer MUST be used

- **NOTE:** Fully agitate the WB EP primer before use. For drying time see manufacturer's process guidelines

- Prepare a mixture of WB EP primer and activator

- With the aid of a commercial syringe draw up the required amount of WB EP primer and activator and pour the materials into a mixing vessel. Fully agitate the mixture of WB EP primer and activator (Processing time of the mixed material is 30 min.)

- **NOTE:** Strictly adhere to the mixing ratio